

Songo Mnara



Msikiti



Mwanzo ya njia



Njia za kupita

Baobabs

These trees are often found in Swahili archaeological sites. This may be because they like to live in soil used by people. Can you get your arms in a hug around a baobab?

Funerary Mosque

This graveyard is the resting place of a 14th century holy man to whom the local people still pray. Look out for offerings, but please leave anything you find where it is!

Mabenchi

Kaa, pumzika unywe maji kidogo. Mabenchi nje ya mlango yalitumika kama sehemu ya familia na marafiki kukusanyika kwaajili ya mazungumzo.



↑ Visitor's Shelter & Maliwato



Friday Mosque

Imagine how many candles it would take to light up rooms this big. Carved cut-outs in the walls held tiny, flickering oil lamps. Can you find at least three openings for these lamps?

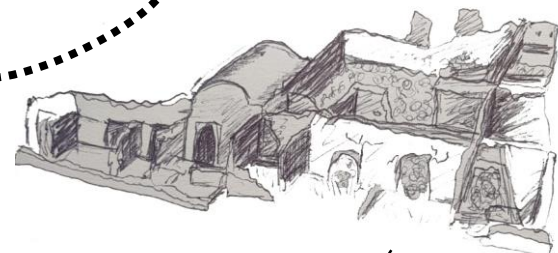

Palace

In the past, the walls were painted bright white and covered with fabric tapestries. You can still see the holes they hung from. Can you find one of these holes?

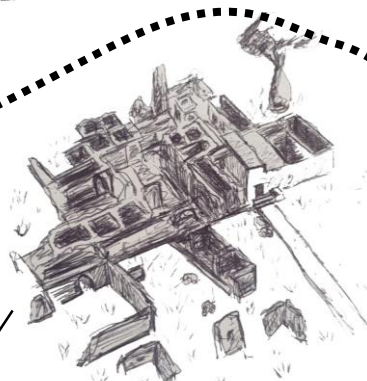

Stone Houses

A long time ago, when these buildings were new, big mangrove trees were cut down to hold the roofs. Can you see the holes that held them?



Je, unaona miti yote ya minazi katika eneo la magofu? Wenyeji wa hapa ndio wenye jukumu la kuotesha na kuitunza. Unaweza kujipatia nazi au dafu - tamu!

Hakikisha unatembelea kijijini, ingawa ni mwendo kidogo kutoka kwenye magofu. Wenyeji ni wakarimu na watakuonyesha vifaa vya kiutamaduni na kilimo cha asili ambacho bado ni sehemu ya maisha yao ya kila siku.

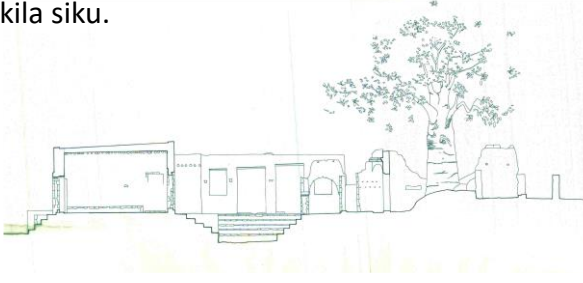

Kumbuka wenyeji wa Songo Mnara wanathamini kisiwa hiki kama nyumbani kwao. Unapotembelea kuwa makini.

Salimia wenyeji kila uwaonapo. Sema “Shikamoo!” kwa wakubwa na “mambo!” au “habari yako!” kwa wadogo.

Vaa nguo za heshima muda wote. Funika mabega na miguu.

Wakati wa mfungo wa mwezi mtukufu wa ramadhani, muulize muongoza watalii sehemu ya faragha ya kupata chakula.

Zingatia usafi wa eneo la urithi.

Mambo ya kujua au kufanya kabla ya kutembelea magofu.

- Pata kibali chako cha kutembelea eneo la urithi katika ofisi ya Mambo ya Kale iliyopo karibu na mamlaka ya bandari.
- Unatakiwa kubeba maji ya kunywa kwakuwa hayapatikani katika eneo husika. Unaweza kubeba na chakula pia, ongea muongoza watalii ili uweze kuandaliwa chakula na wenyeji.
- Maliwato ipo karibu na sehemu ya kupumzikia wageni.
- Kuwa huru kupiga picha za magofu, lakini usipige watu picha bila ya ruhusa yao.
- Kuwa makini unapotembelea, njia nyingine siyo rasmi.



Asanti



Shukurani

- Idara ya Mambo ya Kale, Tanzania
- Kilwa Islands Tours
- Kamati ya Magofu na jamii ya Songo Mnara

Songo Mnara Urithi wa dunia (UNESCO)

Karibu Songo Mnara! Asili ya eneo hili ilikuwa ni sehemu ya maziko na takatifu kwa wenyeji wa Kilwa Kisiwani. Kufikia karne ya 15 eneo hili lilijengeka na kuwa moja ya miji maarufu katika Pwani ya Afrika Mashariki.

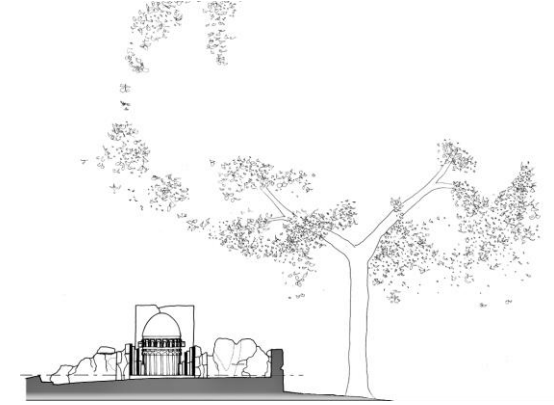

Unapotembelea na kuzunguka kwenye magofu ya Songo Mnara utaona

- Nyumba nyingi zinazoonyesha maisha ya zamani ya kila siku.
- Mabaki ya kasri, ambapo sio kasri, bali ni ukuta wa jengo la mfanyabiashara!
- Msikiti wa ijumaa, ambao una mihrab yenye taswira ya Uswahili wa Pwani.

Katika Kisiwa hiki kunapatikana vitu vya asili kama

- Mapango mazuri yaliyojitengeneza kwenye matumbawe yaliyopo katikati ya magofu na kijiji.
- Misitu ya mikoko inyoonekana wakati unapoelekea kwenye magofu.
- Mbila na nyani wakipanda kwenye magofu.